

## Block 37

Jeff Morgan + Josse Popma  
MArch Design Studio  
University of Illinois, Chicago

Studio Professor: Doug Garofalo

## Block 37

The proposal for Block 37 was envisioned to anchor the north end of State Street, forming an implied axis between the Harold Washington Library and the New Media Center. The two buildings share similar educational responsibilities for the public, offering a variety of programs and facilities. In addition, they also assume a related physical presence on their respective sites, due to a similarity in the size of the building programs.

The controversial history of the site raised many issues concerning the typology of the building. In general, the building considered a multiplicity of programs with the intention of mixing and shifting them throughout the space. The context of the site also provided several interesting elements to take into consideration. For instance, the pedway running between the Red and Blue Lines of the subway bisected the site with a transfer tunnel. The ComEd power utility building needed to remain on the site without interfering with its operations.

Block 37's location in an urban fabric is extremely unique for the fact that almost an entire block in the middle of the city has been left untouched for such a length of time. Its relationship to Daley Plaza and the retail of State Street position it between a significant portion of commercial buildings and a number of civic buildings including City Hall, the State of Illinois building, and Daley Center.

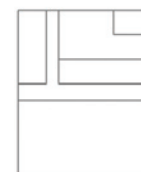
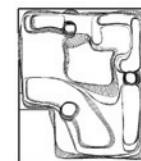
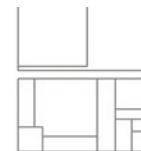
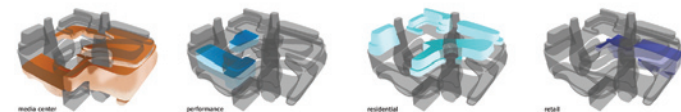

state